

MERY-INSTALL

- C Major Pentatonic
- Recycled HDPE Frame
- Anodized Aluminum Bars and Resonators
- Stainless Steel Hardware

MERRY INSTALLATION GUIDE

Top View

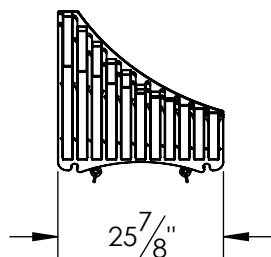

Front View

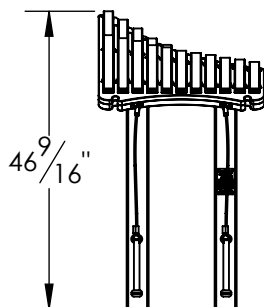

Side View

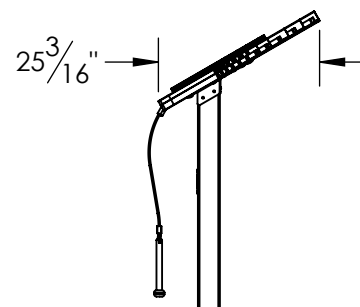

MERY-IG-REC

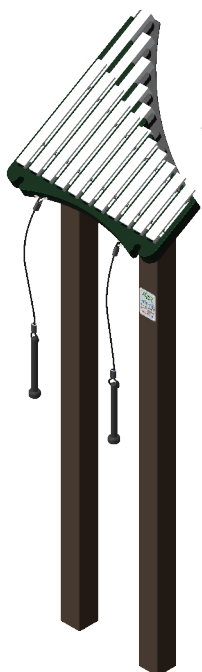

MERY-SM-REC

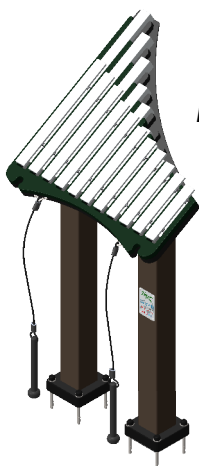

MERY-PM-REC



MERY-IG-STL

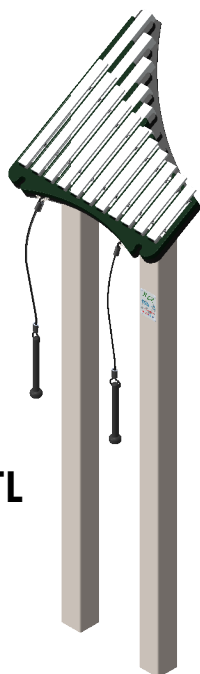

MERY-SM-STL

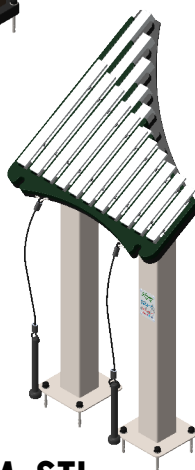

MERY-PM-STL

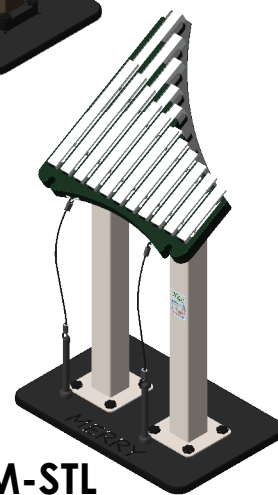

Inground, Sheet 2 and 3
Assembled Weight: ?
Combined Packaged Weight: ?

Surface Mount, Sheet 2 and 4
Assembled Weight: ?
Combined Packaged Weight: ?

Portable Mount, Sheet 2 and 5
Assembled Weight: ?
Combined Packaged Weight: ?

Assembly Instructions

1. Begin by mounting the Holsters to the back of the Instrument with the provided #8 Flat Head Screws and T15 Driver. The back is predrilled for the screws. Screw heads should be flush with the face of the Holster when properly installed and the Holster should also be flush along the back. Drive screws slowly to prevent stripping. Make sure that the Holsters are orientated as shown below so that when installed the Instrument will sit at a 30° angle.
2. With two people, situate the Instrument with Holsters attached onto the Posts. Posts come predrilled and/or tapped. Fasten the Instrument to the Posts with the provided #8 Button Head Screw for Recycled Posts or #10-24 Button Head Machine Screw for Steel Posts. Drivers are provided. Portable Options come with #10-24 Thumb Screws for ease of assembly and disassembly.

ITEM NO.	PART NUMBER	DESCRIPTION	Recycled QTY.	Steel QTY.	Portable QTY.
1	MERY-BOM	Pre-Assembly - Merry Instrument	1	1	1
2	HLSTR-SM-SS	Small SS Holdter	2	2	2
3	8N125TFTS	#8 Flat Head Screw, 1.25"lg. SS, T15 tamp	8	8	8
4	8N125BTBS	#8 Button Head Screw, 1.25"lg. SS, T15 tamp	10	-	-
5	10C100MBTS	#10-24 Button Head Machine Screw, 1"lg. SS, T25 tamp	-	10	-
6	91185A346	#10-24 Thumb Screw, .5"lg. SS	-	-	8
7	12260B	T15 x 1" Driver (Tamper Resistant)	1	1	1
8	12192	T25 x 1" Driver (Tamper Resistant)	-	1	-

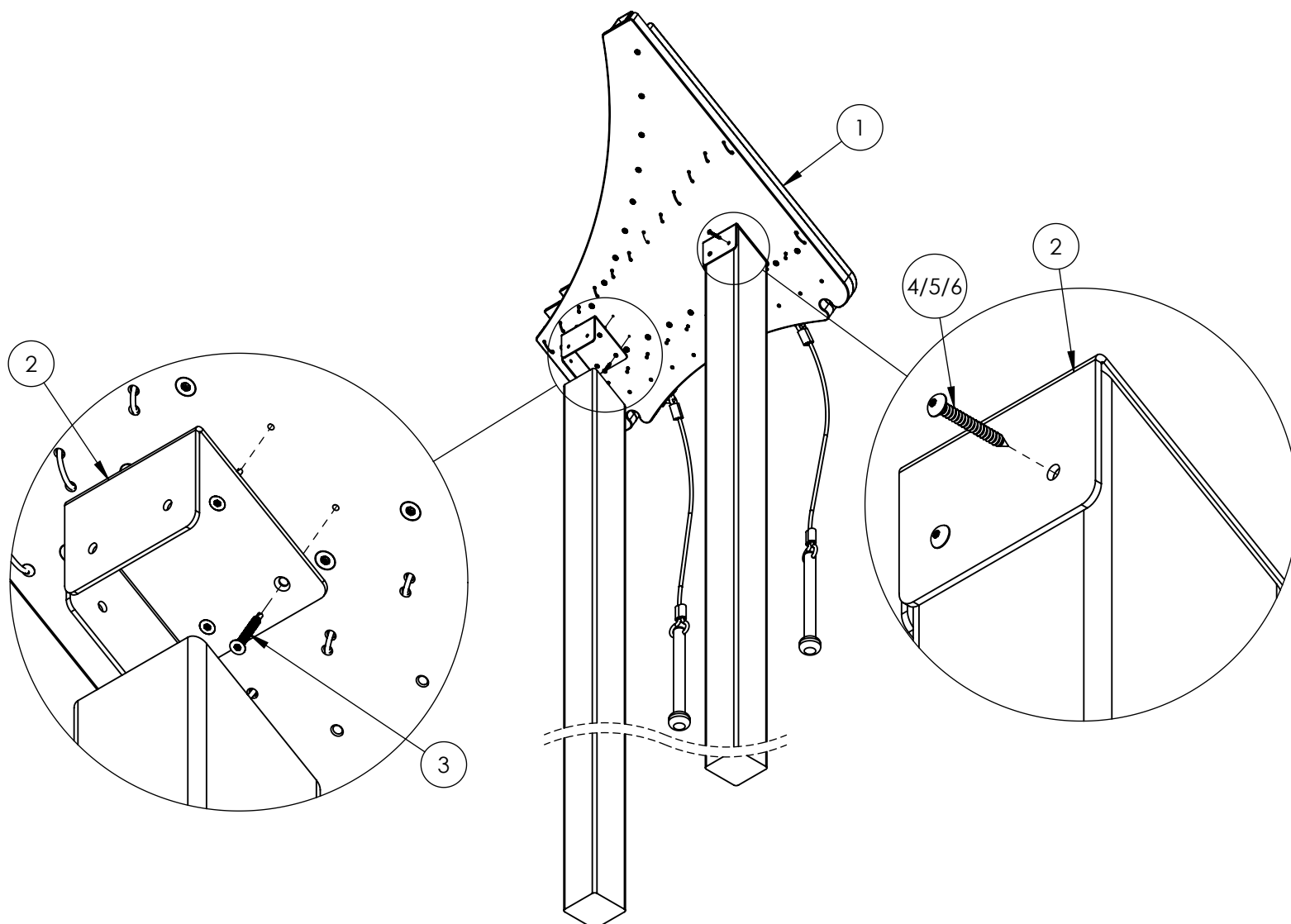

Inground Installation Instructions

1. Excavate two 10" diameter holes, 36" deep, and 13.75" on center at the installation location. (A deeper excavated hole or shortening the In Ground Post will be required if the desired age groups are between 2-12) Be sure to account for surfacing thickness if it is to be used.
Post Length = Frost Depth (36" Recommended) + Finished Post Height
Finished Post Height Guideline: (Ages 2-5, 28") (Ages 5-12, 32") (Ages 13+, 36")
2. With two people, lower the Posts with the Instrument attached into the excavated holes. Verify the correct placement, levelness, and finished height of the Instrument. Check for sufficient clearance around the Instrument, a 36" perimeter around the Instrument is recommended for wheelchair accessibility.
3. Last pour concrete around the posts. It is recommended to brace the Instrument to hold it rigid while the concrete cures. Leave to set according to the concrete manufacturers guidelines. Approximately (6) 80lb. bags will be needed.

ITEM NO.	PART NUMBER	DESCRIPTION	In Ground Recycled QTY.	In Ground Steel QTY.
1	MERY-BOM	Pre-Assembly - Merry Instrument	1	1
2	POST-REC-72-DEG30	In Ground Recycled Post, 72"lg.	1	-
3	POST-REC-72-DEG30-SIGN	In Ground Recycled Post, 72"lg. w/ Name Plate	1	-
4	POST-STL-72-DEG30-FP	In Ground Steel Post, 72"lg. (Powder-coated)	-	1
5	POST-STL-72-DEG30-SIGN	In Ground Steel Post, 72"lg. w/ Name Plate (Powder-coated)	-	1

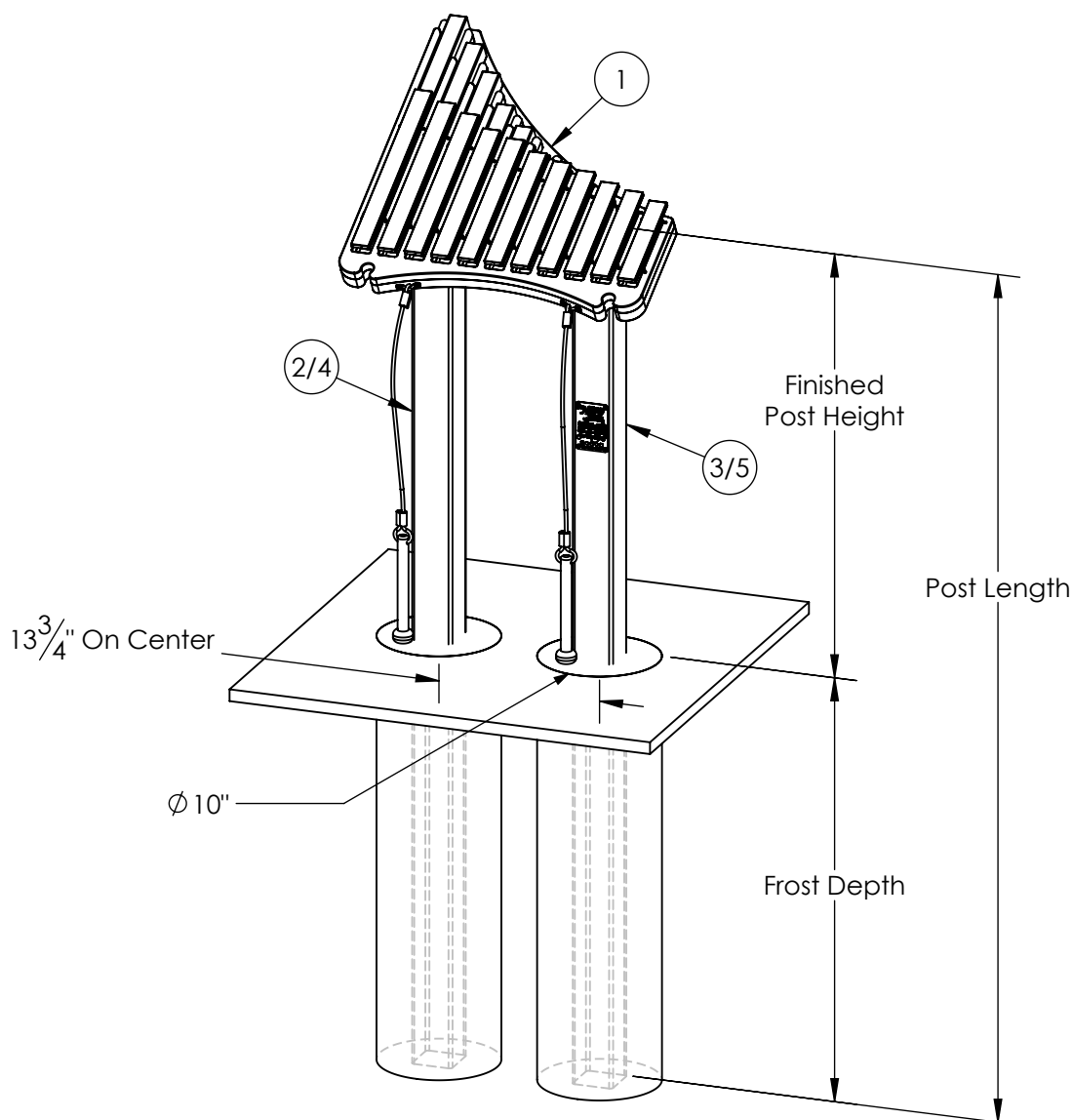

Surface Mount Installation Instructions

- Standard finished height for the Surface Mount Posts are 36". (Recessing the concrete pad below the finished surfacing or shortening the Surface Mount Recycled Post will be required if desired age groups are between 2-12. The height of the Surface Mount Steel Posts can not be adjusted) Be sure to account for surfacing thickness if it is to be used.
Finished Post Height Guideline: (Ages 2-5, 28") (Ages 5-12, 32") (Ages 13+, 36")
- Determine installation location. Verify concrete pad is a minimum of 36" long x 24" wide x 6" thick. If the concrete pad is at an angle, steel washers are required to act as shims (Shims not provided). If there is not already an existing pad, approximately (5) 80lb. bags will be needed. Allow concrete to cure per concrete manufacturers guidelines.
- With two people place the Instrument Assembly onto the concrete pad and mark the center of the holes on the surface mount bases. After you have made your marks, set aside the Instrument in order to drill for anchor holes. With a hammer or rotary drill, drill through concrete at marked locations. Drill to a minimum depth of 4". A 3/8" masonry drill bit will be needed.
- Place the Instrument back over the drilled out holes. Insert provided anchor bolts into aligned holes. Position anchor nut so that it is flush with the top of the bolt. Pound anchor bolts into the hole until the anchor washer is flush with the surface mount base. Tighten anchor bolts until they are snug. Cover remaining bolt sections with provided nut caps.
- Verify the correct placement, levelness, and finished height of the Instrument. Check for sufficient clearance around the Instrument, a 36" perimeter around the Instrument is recommended for wheelchair accessibility.
- If installing onto wet concrete, us the wet set anchor manufacturers guidelines for installation procedures.

ITEM NO.	PART NUMBER	DESCRIPTION	Surface Mount Recycled QTY.	Surface Mount Steel QTY.
1	MERY-BOM	Pre-Assembly - Merry Instrument	1	1
2	POST-REC-36-DEG30	Surface Mount Recycled Post, 36"lg.	1	-
3	POST-REC-36-DEG30-SIGN	Surface Mount Recycled Post, 36"lg. w/ Name Plate	1	-
4	SM-BASE-REC	Surface Mount Base HDPE, For Recycled Post (1.5" Black)	2	-
5	POST-STL-36-DEG30-FP	Surface Mount Steel Post, 36"lg. (Powder-coated)	-	1
6	POST-STL-36-DEG30-SIGN	Surface Mount Steel Post, 36"lg. w/ Name Plate (Powder-coated)	-	1
7	POW 07316	3/8"-16 Wedge Expansion Anchor, 5"lg. SS	8	-
8	POW 07315	3/8"-16 Wedge Expansion Anchor, 3.75"lg. SS	-	8
9	9267K43	35/64" Hex Nut Cap	8	8

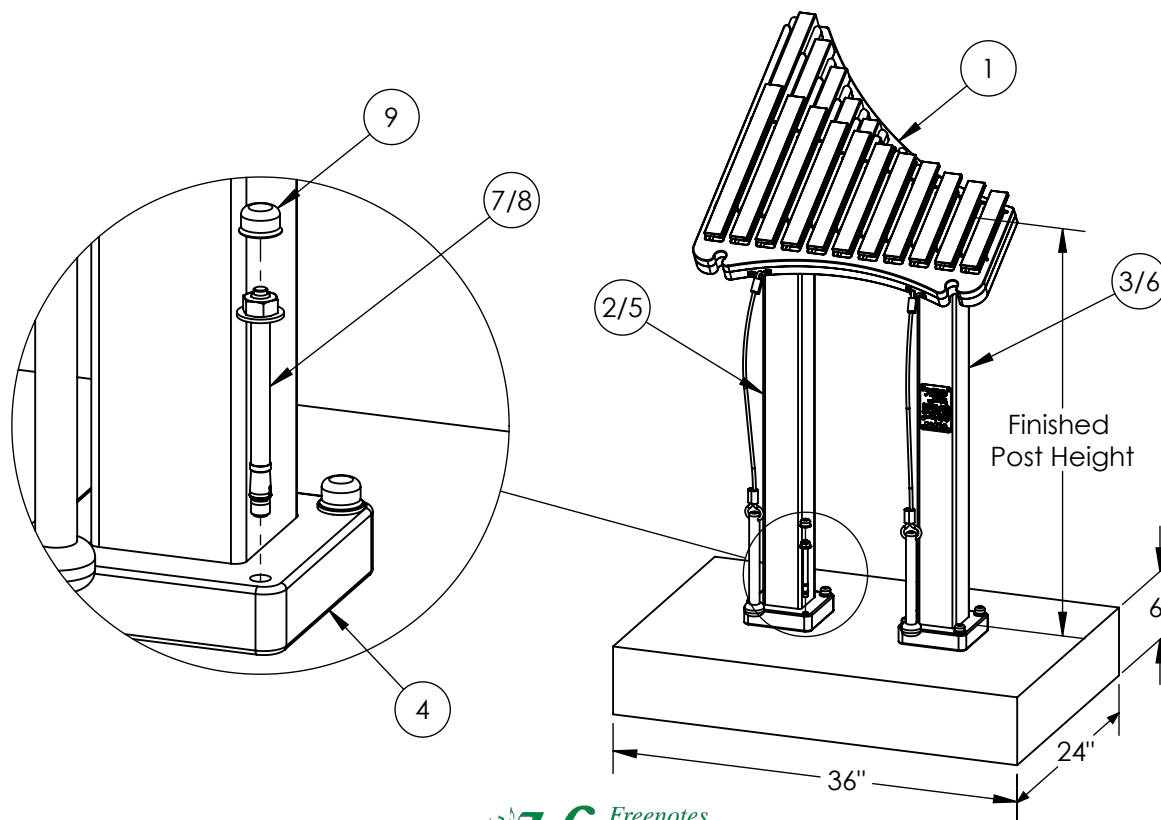

Portable Mount Installation Instructions

- Standard finished height for the Portable Mount Posts are 36". (Shortening the Surface Mount Recycled Post will be required if desired age groups are between 2-12. The height of the Surface Mount Steel Posts can not be adjusted)
Finished Post Height Guideline: (Ages 2-5, 28") (Ages 5-12, 32") (Ages 13+, 36")
- With two people have one situate the Instrument Assembly onto the Portable Stand and align the holes.
- Have the second person secure the Instrument to the Portable Stand with the provided 3/8"-16 Thumb Screws. Thumb Screws should be tightened snugly to prevent any raddling during play. The 3/8"-16 Hex Nuts are pre-pressed into the Portable Stand from the Factory.

ITEM NO.	PART NUMBER	DESCRIPTION	Portable Mount Recycled QTY.	Portable Mount Steel QTY.
1	MERY-BOM	Pre-Assembly - Merry Instrument	1	1
2	MERY-PM-PS	Merry - HDPE Portable Stand (1" Black)	1	1
3	POST-REC-36-DEG30	Surface Mount Recycled Post, 36"lg.	1	-
4	POST-REC-36-DEG30-SIGN	Surface Mount Recycled Post, 36"lg. w/ Name Plate	1	-
5	SM-BASE-REC	Surface Mount Base HDPE, For Recycled Post (1.5" Black)	2	-
6	POST-STL-36-DEG30-FP	Surface Mount Steel Post, 36"lg. (Powder-coated)	-	1
7	POST-STL-36-DEG30-SIGN	Surface Mount Steel Post, 36"lg. w/ Name Plate (Powder-coated)	-	1
8	91845A031	3/8"-16 Hex Nut, SS	16	16
9	91185A867	3/8"-16 Thumb Screw, 1"lg. SS	-	8
10	92198A634	3/8"-16 Hex Head Screw, 2.5"lg. SS	8	-
11	94052A046	3/8" Socket Head Knob	8	-

